

**NOTICE OF TAX ABATEMENT CONSIDERATION
HANSFORD COUNTY HOSPITAL DISTRICT**

DATE: May 26, 2021

TIME: 6:00 P.M.

PLACE: Conference Room, Hansford County Hospital, 707 Rowland St., Spearman Texas 79081

PURPOSE: The Hansford County Hospital District will discuss and take possible action regarding a tax abatement agreement with Firewheel Wind Energy, LLC, pursuant to Chapter 312 of the Texas Tax Code.

Property Owner and Applicant for Tax Abatement: Firewheel Wind Energy, LLC

Reinvestment Zone: Firewheel Wind Energy, LLC 2 Reinvestment Zone

Property in Reinvestment Zone: See attached map and legal description provided in Exhibit "A" attached hereto and incorporated herein for all purposes.

Anticipated Improvements: The general description of the nature of the improvements included in the agreement is as follows:

Firewheel Wind Energy, LLC anticipates constructing a 358 MW wind farm of which 335 MW will be in Hansford County. Improvements would include (but are not limited to) wind turbines, towers, foundations, transformers, pad mounts, underground collection systems, transmission lines, electrical interconnections, met towers, roads, O&M, building, electrical substation, control systems and all eligible ancillary and necessary equipment for commercial wind generation of electricity.

Estimated Cost of the Improvements: The estimated cost of the improvements being contemplated by Firewheel Wind Energy, LLC is approximately \$313,089,821.00.

FOR DETAILED INFORMATION OR QUESTIONS CALL JONATHAN BAILEY AT 806-659-2535

CERTIFICATION

I certify that the above Notice of Tax Abatement Consideration (including the map and Exhibit "A") was posted at the Hansford County Hospital at a place readily accessible to the general public at all times on the ____ day of April, 2021, and pursuant to Texas Tax Code 312.207 and Chapter 551, Texas Government Code, said Notice remained so posted continuously for at least 30 days preceding the scheduled time of said Meeting.

Jonathan Bailey, CEO
Hansford County Hospital District

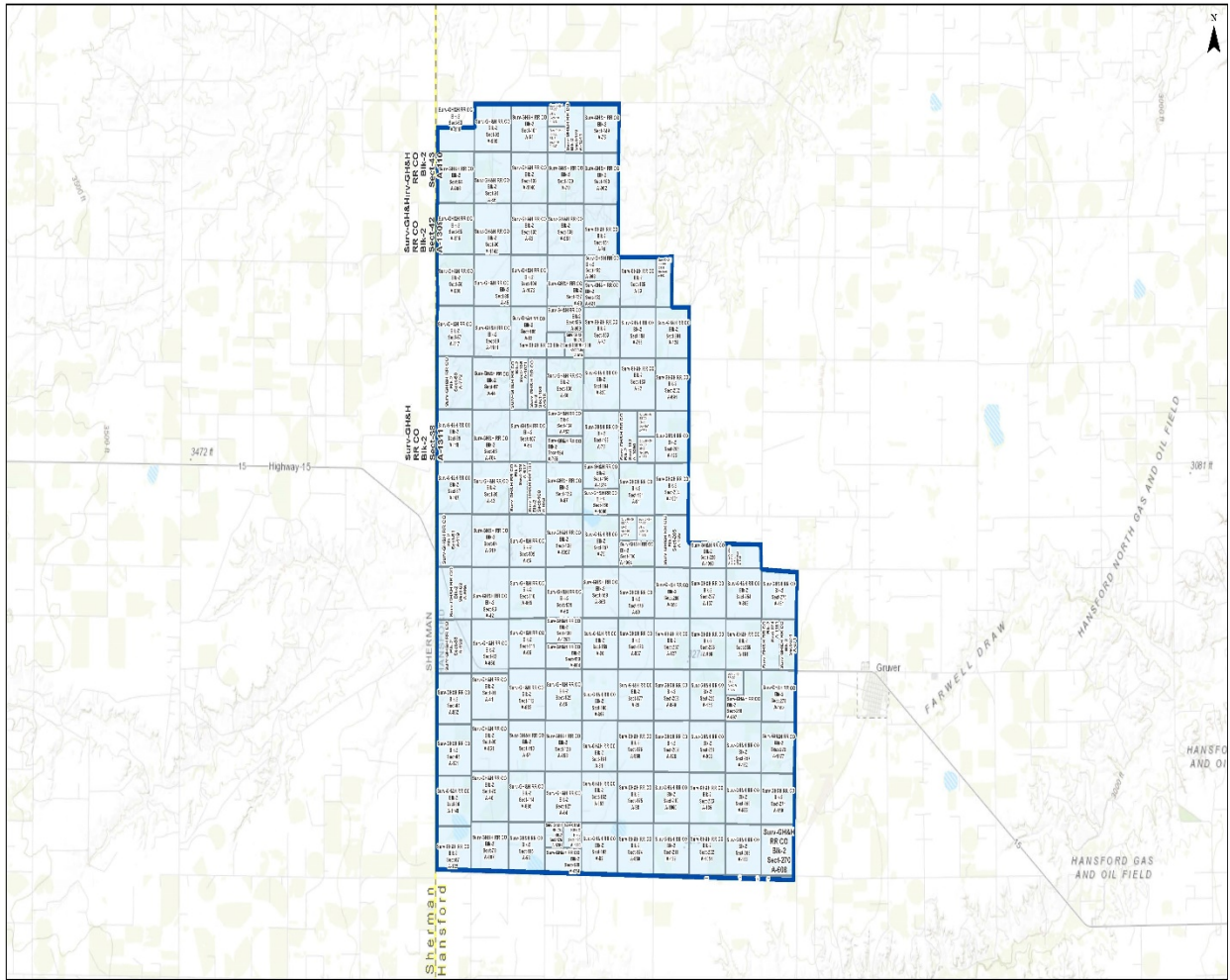

- Project Boundary
- Reinvestment Zone
- Texas Survey

Firewheel Central

Hansford, Texas

Exhibit Date: 4/9/2021



3.5

Miles

Exhibit "A"

ABSTRACT	SURVEY NAME	BLOCK	SECTION
1951313	GH&H RR CO	2	44
195115	GH&H RR CO	2	53
195989	GH&H RR CO	2	92
19551	GH&H RR CO	2	101
1951242	GH&H RR CO	2	140
1951241	GH&H RR CO	2	140
19575	GH&H RR CO	2	149
1951143	GH&H RR CO	2	140
195110	GH&H RR CO	2	43
195986	GH&H RR CO	2	54
19546	GH&H RR CO	2	91
1951140	GH&H RR CO	2	102
19570	GH&H RR CO	2	139
195962	GH&H RR CO	2	150
1951309	GH&H RR CO	2	42
195116	GH&H RR CO	2	55
1951142	GH&H RR CO	2	90
19552	GH&H RR CO	2	103
195961	GH&H RR CO	2	138
19576	GH&H RR CO	2	151
195109	GH&H RR CO	2	41
195988	GH&H RR CO	2	56
19545	GH&H RR CO	2	89
1951072	GH&H RR CO	2	104
19569	GH&H RR CO	2	137
195963	GH&H RR CO	2	152
19593	GH&H RR CO	2	185
195621	GH&H RR CO	2	152
1951319	GH&H RR CO	2	40
195117	GH&H RR CO	2	57
1951141	GH&H RR CO	2	88
19553	GH&H RR CO	2	105
195959	GH&H RR CO	2	136
19577	GH&H RR CO	2	153
195756	GH&H RR CO	2	184
1951314	GH&H RR CO	2	40
1951288	GH&H RR CO	2	136
195616	GH&H RR CO	2	136
195108	GH&H RR CO	2	39
195772	GH&H RR CO	2	58

19544	GH&H RR CO	2	87
1951071	GH&H RR CO	2	106
195618	GH&H RR CO	2	106
19568	GH&H RR CO	2	135
195620	GH&H RR CO	2	154
19592	GH&H RR CO	2	183
1951311	GH&H RR CO	2	38
195118	GH&H RR CO	2	59
195754	GH&H RR CO	2	86
19554	GH&H RR CO	2	107
195753	GH&H RR CO	2	134
19578	GH&H RR CO	2	155
1951095	GH&H RR CO	2	182
1951316	GH&H RR CO	2	182
195755	GH&H RR CO	2	134
1951208	GH&H RR CO	2	182
195773	GH&H RR CO	2	60
195107	GH&H RR CO	2	37
19543	GH&H RR CO	2	85
195617	GH&H RR CO	2	108
195984	GH&H RR CO	2	108
19567	GH&H RR CO	2	133
1951374	GH&H RR CO	2	156
19591	GH&H RR CO	2	181
1951096	GH&H RR CO	2	156
1951372	GH&H RR CO	2	156
195664	GH&H RR CO	2	36
195119	GH&H RR CO	2	61
195619	GH&H RR CO	2	84
19555	GH&H RR CO	2	109
1951097	GH&H RR CO	2	132
19579	GH&H RR CO	2	157
1951315	GH&H RR CO	2	180
1951207	GH&H RR CO	2	180
1951094	GH&H RR CO	2	180
195106	GH&H RR CO	2	35
195665	GH&H RR CO	2	62
19542	GH&H RR CO	2	83
195865	GH&H RR CO	2	110
19566	GH&H RR CO	2	131
195866	GH&H RR CO	2	158
19590	GH&H RR CO	2	179
195120	GH&H RR CO	2	63

195860	GH&H RR CO	2	82
19571	GH&H RR CO	2	34
19556	GH&H RR CO	2	111
1951293	GH&H RR CO	2	130
19580	GH&H RR CO	2	159
195857	GH&H RR CO	2	178
195864	GH&H RR CO	2	130
195863	GH&H RR CO	2	112
19565	GH&H RR CO	2	129
195867	GH&H RR CO	2	160
19589	GH&H RR CO	2	177
195105	GH&H RR CO	2	33
195862	GH&H RR CO	2	64
19541	GH&H RR CO	2	81
195692	GH&H RR CO	2	200
195124	GH&H RR CO	2	201
195691	GH&H RR CO	2	202
195125	GH&H RR CO	2	203
1951091	GH&H RR CO	2	204
195126	GH&H RR CO	2	205
195150	GH&H RR CO	2	253
1951090	GH&H RR CO	2	228
195856	GH&H RR CO	2	206
195137	GH&H RR CO	2	227
195869	GH&H RR CO	2	254
195161	GH&H RR CO	2	275
195127	GH&H RR CO	2	207
195996	GH&H RR CO	2	226
195151	GH&H RR CO	2	255
1951181	GH&H RR CO	2	274
195871	GH&H RR CO	2	274
195999	GH&H RR CO	2	208
195136	GH&H RR CO	2	225
1951258	GH&H RR CO	2	256
195997	GH&H RR CO	2	256
195160	GH&H RR CO	2	273
195121	GH&H RR CO	2	65
195861	GH&H RR CO	2	80
19557	GH&H RR CO	2	113
195853	GH&H RR CO	2	128
19581	GH&H RR CO	2	161
195858	GH&H RR CO	2	176
19540	GH&H RR CO	2	79

195885	GH&H RR CO	2	114
19564	GH&H RR CO	2	127
195852	GH&H RR CO	2	162
19588	GH&H RR CO	2	175
1951148	GH&H RR CO	2	66
195887	GH&H RR CO	2	78
19558	GH&H RR CO	2	115
1951294	GH&H RR CO	2	126
1951220	GH&H RR CO	2	126
19582	GH&H RR CO	2	163
195122	GH&H RR CO	2	67
195859	GH&H RR CO	2	174
195854	GH&H RR CO	2	126
195128	GH&H RR CO	2	209
195998	GH&H RR CO	2	224
195152	GH&H RR CO	2	257
1951177	GH&H RR CO	2	272
1951050	GH&H RR CO	2	210
195135	GH&H RR CO	2	223
195685	GH&H RR CO	2	258
195159	GH&H RR CO	2	271
195129	GH&H RR CO	2	211
1951051	GH&H RR CO	2	222
195153	GH&H RR CO	2	259
195608	GH&H RR CO	2	270